

3029 South 26th Avenue
Broadview, Illinois
(708) 410-1780

www.jallo.com
sales@jallo.com

JALLO

Equipment and Supply, Inc.

The Orion Dry Vane Vacuum pump Model KRX-3
Capable of vacuum levels up to 25 inches of Mercury,
Pressure levels consistently at 8.5 PSI
10 Cubic Feet Per Minute
Motor Speeds is 1750 RPM
Motor size is .5 HP
Weight is approximately 35-45 lbs

The Orion KRX-3 is no longer in production, a direct replacement would be the Jallo [JVP-3](#)

#	Part name	Part number	
1	Vacuum Regulator	3039289010	1
2	Pressure Regulator	3000049010	1
3	Pressure Gauge	4002320010	1
4	Vacuum Gauge	4039371010	1
*5	SDX Case Complete		1
6	Manifold Bolt		2
*7	Manifold Cap	3039287020	2
8	Manifold Cap Gasket	3039292010	2
9	SDX Case	1031013010	1
10	Plug	4039361010	
11	Filter Rod	4039360040	2
12	Filter	4000028010	2
13	Spring	40393590010	2
14	Filter Gasket	3039263010	2
15	Filter Case KRX-3	3039259010	1
16	Gasket Washer	4000695010	2
17	Knob	4034947010	2
18	Muffler Cover	3039260010	1
19	Pump Only KRX-3		
20	Manifold Gasket	4009579010	
21	Fan Housing Guard	3039901010	1
22	Fan	2034550010	1
23	Bearing Cover	4009952010	2
24	Liner/Shim		
25	Bearing	39004116220	2
26	Bearing Retainer Stop	4009353010	2
27	Side Plate F.S.	3039266010	1
28	Pin	33611111300	4
29	Rotor	3039273010	1
30	Key	33300412000	1
31	Vane/Blade	4009564010	4
32	Pump Housing KRX-3	2034516010	1
33	Side Plate M.S.	3039267010	1
34	Pump Side Coupling	4034905010	1
35	Spider	4002338010	1
36	Motor Side Coupling	4034905020	1
37	Motor		1
38	Coupling Guard	3036521010	1
39	Base		1

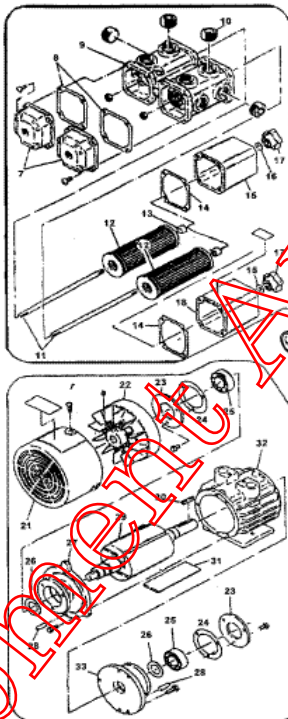

Jallo Equipment & Supply Inc.
3029 26th Avenue
Broadview, IL 60155
(708) 410-1780/fax 1790
www.jallo.com E-mail: jallo@ais.net

Orion Vacuum Pump
Model KRX-3
Parts Breakdown

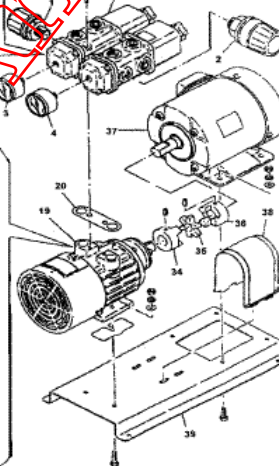

REBUILD KIT



VANES



PUMPS